



**HANSON RIVET & SUPPLY CO.**  
13241 Weidner Street  
Pacoima, CA 91331

Phone: 818-485-0500

FAX: 818-485-0540

Outside CA: 1-800-RRRIVET

[www.hansonrivet.com](http://www.hansonrivet.com)

CLICK ON PART NUMBER  
TO PRICE OR BUY



# SQUEEZER DIES



PART NUMBER: \_\_\_\_\_ DIE STYLE: \_\_\_\_\_

**CA2000 ROUND HEAD**

RETAINER SPRING  
(Part # CA2601)

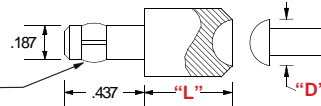

"D" HEAD DIAMETER



## RIVET HEAD DIAMETER

"D" .125 DIA.		"D" .187 DIA.		"D" .250 DIA.		"D" .312 DIA.		"D" .375 DIA.		"D" .500 DIA.		"D" .625 DIA.		"D" .750 DIA.	
"L"	PART No.	"L"	PART No.	"L"	PART No.	"L"	PART No.	"L"	PART No.	"L"	PART No.	"L"	PART No.	"L"	PART No.
1/8	CA2000-01x	1/8	CA2000-1x	1/8	CA2000-8x	1/8	CA2000-15x	1/8	CA2000-22x	1/8	CA2000-29x	1/8	CA2000-36x	1/8	CA2000-43x
1/4	CA2000-01	1/4	CA2000-1	1/4	CA2000-8	1/4	CA2000-15	1/4	CA2000-22	1/4	CA2000-29	1/4	CA2000-36	1/4	CA2000-43
3/8	CA2000-02	3/8	CA2000-2	3/8	CA2000-9	3/8	CA2000-16	3/8	CA2000-23	3/8	CA2000-30	3/8	CA2000-37	3/8	CA2000-44
1/2	CA2000-03	1/2	CA2000-3	1/2	CA2000-10	1/2	CA2000-17	1/2	CA2000-24	1/2	CA2000-31	1/2	CA2000-38	1/2	CA2000-45
5/8	CA2000-04	5/8	CA2000-4	5/8	CA2000-11	5/8	CA2000-18	5/8	CA2000-25	5/8	CA2000-32	5/8	CA2000-39	5/8	CA2000-46
3/4	CA2000-05	3/4	CA2000-5	3/4	CA2000-12	3/4	CA2000-19	3/4	CA2000-26	3/4	CA2000-33	3/4	CA2000-40	3/4	CA2000-47
7/8	CA2000-06	7/8	CA2000-6	7/8	CA2000-13	7/8	CA2000-20	7/8	CA2000-27	7/8	CA2000-34	7/8	CA2000-41	7/8	CA2000-48
1	CA2000-07	1	CA2000-7	1	CA2000-14	1	CA2000-21	1	CA2000-28	1	CA2000-35	1	CA2000-42	1	CA2000-49

PART NUMBER: \_\_\_\_\_ DIE STYLE: \_\_\_\_\_

**CA2001 BRAZIER HEAD**

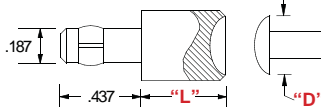

"D" HEAD DIAMETER



## RIVET HEAD DIAMETER

"D" .156 DIA.		"D" .234 DIA.		"D" .312 DIA.		"D" .391 DIA.		"D" .469 DIA.		"D" .625 DIA.		"D" .781 DIA.		"D" .937 DIA.	
"L"	PART No.	"L"	PART No.	"L"	PART No.	"L"	PART No.	"L"	PART No.	"L"	PART No.	"L"	PART No.	"L"	PART No.
1/8	CA2001-01x	1/8	CA2001-1x	1/8	CA2001-8x	1/8	CA2001-15x	1/8	CA2001-22x	1/8	CA2001-29x	1/8	CA2001-36x	1/8	CA2001-43x
1/4	CA2001-01	1/4	CA2001-1	1/4	CA2001-8	1/4	CA2001-15	1/4	CA2001-22	1/4	CA2001-29	1/4	CA2001-36	1/4	CA2001-43
3/8	CA2001-02	3/8	CA2001-2	3/8	CA2001-9	3/8	CA2001-16	3/8	CA2001-23	3/8	CA2001-30	3/8	CA2001-37	3/8	CA2001-44
1/2	CA2001-03	1/2	CA2001-3	1/2	CA2001-10	1/2	CA2001-17	1/2	CA2001-24	1/2	CA2001-31	1/2	CA2001-38	1/2	CA2001-45
5/8	CA2001-04	5/8	CA2001-4	5/8	CA2001-11	5/8	CA2001-18	5/8	CA2001-25	5/8	CA2001-32	5/8	CA2001-39	5/8	CA2001-46
3/4	CA2001-05	3/4	CA2001-5	3/4	CA2001-12	3/4	CA2001-19	3/4	CA2001-26	3/4	CA2001-33	3/4	CA2001-40	3/4	CA2001-47
7/8	CA2001-06	7/8	CA2001-6	7/8	CA2001-13	7/8	CA2001-20	7/8	CA2001-27	7/8	CA2001-34	7/8	CA2001-41	7/8	CA2001-48
1	CA2001-07	1	CA2001-7	1	CA2001-14	1	CA2001-21	1	CA2001-28	1	CA2001-35	1	CA2001-42	1	CA2001-49

PART NUMBER: \_\_\_\_\_ DIE STYLE: \_\_\_\_\_

**CA2002 UNIVERSAL HEAD**

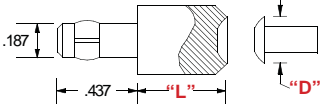

"D" HEAD DIAMETER



## RIVET HEAD DIAMETER

"D" .125 DIA.		"D" .187 DIA.		"D" .250 DIA.		"D" .312 DIA.		"D" .375 DIA.		"D" .500 DIA.		"D" .625 DIA.		"D" .750 DIA.	
"L"	PART No.	"L"	PART No.	"L"	PART No.	"L"	PART No.	"L"	PART No.	"L"	PART No.	"L"	PART No.	"L"	PART No.
1/8	CA2002-01x	1/8	CA2002-1x	1/8	CA2002-8x	1/8	CA2002-15x	1/8	CA2002-22x	1/8	CA2002-29x	1/8	CA2002-36x	1/8	CA2002-43x
1/4	CA2002-01	1/4	CA2002-1	1/4	CA2002-8	1/4	CA2002-15	1/4	CA2002-22	1/4	CA2002-29	1/4	CA2002-36	1/4	CA2002-43
3/8	CA2002-02	3/8	CA2002-2	3/8	CA2002-9	3/8	CA2002-16	3/8	CA2002-23	3/8	CA2002-30	3/8	CA2002-37	3/8	CA2002-44
1/2	CA2002-03	1/2	CA2002-3	1/2	CA2002-10	1/2	CA2002-17	1/2	CA2002-24	1/2	CA2002-31	1/2	CA2002-38	1/2	CA2002-45
5/8	CA2002-04	5/8	CA2002-4	5/8	CA2002-11	5/8	CA2002-18	5/8	CA2002-25	5/8	CA2002-32	5/8	CA2002-39	5/8	CA2002-46
3/4	CA2002-05	3/4	CA2002-5	3/4	CA2002-12	3/4	CA2002-19	3/4	CA2002-26	3/4	CA2002-33	3/4	CA2002-40	3/4	CA2002-47
7/8	CA2002-06	7/8	CA2002-6	7/8	CA2002-13	7/8	CA2002-20	7/8	CA2002-27	7/8	CA2002-34	7/8	CA2002-41	7/8	CA2002-48
1	CA2002-07	1	CA2002-7	1	CA2002-14	1	CA2002-21	1	CA2002-28	1	CA2002-35	1	CA2002-42	1	CA2002-49



**HANSON RIVET & SUPPLY CO.**  
13241 Weidner Street  
Pacoima, CA 91331

Phone: 818-485-0500

FAX: 818-485-0540

Outside CA: 1-800-RRRIVET

[www.hansonrivet.com](http://www.hansonrivet.com)



# SQUEEZER DIES



PART NUMBER: \_\_\_\_\_ DIE STYLE: \_\_\_\_\_



## CA2003 FLUSH STYLE

"D" DIA.= 3/8"		"D" DIA.= 1/2"		"D" DIA.= 3/4"		"D" DIA.= 1"	
"L"	PART No.	"L"	PART No.	"L"	PART No.	"L"	PART No.
1/8	CA2003-1	1/8	CA2003-16	1/8	CA2003-31	1/8	CA2003-46
3/16	CA2003-2	3/16	CA2003-17	3/16	CA2003-32	3/16	CA2003-47
1/4	CA2003-3	1/4	CA2003-18	1/4	CA2003-33	1/4	CA2003-48
5/16	CA2003-4	5/16	CA2003-19	5/16	CA2003-34	5/16	CA2003-49
3/8	CA2003-5	3/8	CA2003-20	3/8	CA2003-35	3/8	CA2003-50
7/16	CA2003-6	7/16	CA2003-21	7/16	CA2003-36	7/16	CA2003-51
1/2	CA2003-7	1/2	CA2003-22	1/2	CA2003-37	1/2	CA2003-52
9/16	CA2003-8	9/16	CA2003-23	9/16	CA2003-38	9/16	CA2003-53
5/8	CA2003-9	5/8	CA2003-24	5/8	CA2003-39	5/8	CA2003-54
11/16	CA2003-10	11/16	CA2003-25	11/16	CA2003-40	11/16	CA2003-55
3/4	CA2003-11	3/4	CA2003-26	3/4	CA2003-41	3/4	CA2003-56

SHOULDER STYLE	
"L"	PART No.
1/8	CA2003-61
3/16	CA2003-62
1/4	CA2003-63
5/16	CA2003-64
3/8	CA2003-65
7/16	CA2003-66
1/2	CA2003-67
9/16	CA2003-68
5/8	CA2003-69
11/16	CA2003-70
3/4	CA2003-71

PART NUMBER: \_\_\_\_\_ DIE STYLE: \_\_\_\_\_

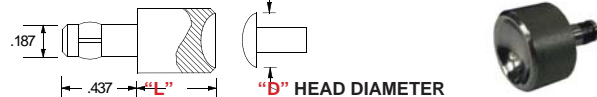

## CA2004 OVAL/TRUSS HEAD

RIVET HEAD DIAMETER															
"D" 1/8 DIA.		"D" 5/32 DIA.		"D" 7/32 DIA.		"D" 5/16 DIA.		"D" 3/8 DIA.		"D" 7/16 DIA.		"D" 5/8 DIA.		"D" 3/4 DIA.	
"L"	PART No.	"L"	PART No.	"L"	PART No.	"L"	PART No.	"L"	PART No.	"L"	PART No.	"L"	PART No.	"L"	PART No.
1/8	CA2004-01x	1/8	CA2004-1x	1/8	CA2004-8x	1/8	CA2004-15x	1/8	CA2004-22x	1/8	CA2004-29x	1/8	CA2004-36x	1/8	CA2004-43x
1/4	CA2004-01	1/4	CA2004-1	1/4	CA2004-8	1/4	CA2004-15	1/4	CA2004-22	1/4	CA2004-29	1/4	CA2004-36	1/4	CA2004-43
3/8	CA2004-02	3/8	CA2004-2	3/8	CA2004-9	3/8	CA2004-16	3/8	CA2004-23	3/8	CA2004-30	3/8	CA2004-37	3/8	CA2004-44
1/2	CA2004-03	1/2	CA2004-3	1/2	CA2004-10	1/2	CA2004-17	1/2	CA2004-24	1/2	CA2004-31	1/2	CA2004-38	1/2	CA2004-45
5/8	CA2004-04	5/8	CA2004-4	5/8	CA2004-11	5/8	CA2004-18	5/8	CA2004-25	5/8	CA2004-32	5/8	CA2004-39	5/8	CA2004-46
3/4	CA2004-05	3/4	CA2004-5	3/4	CA2004-12	3/4	CA2004-19	3/4	CA2004-26	3/4	CA2004-33	3/4	CA2004-40	3/4	CA2004-47
7/8	CA2004-06	7/8	CA2004-6	7/8	CA2004-13	7/8	CA2004-20	7/8	CA2004-27	7/8	CA2004-34	7/8	CA2004-41	7/8	CA2004-48
1	CA2004-07	1	CA2004-7	1	CA2004-14	1	CA2004-21	1	CA2004-28	1	CA2004-35	1	CA2004-42	1	CA2004-49

PART NUMBER: \_\_\_\_\_ DIE STYLE: \_\_\_\_\_

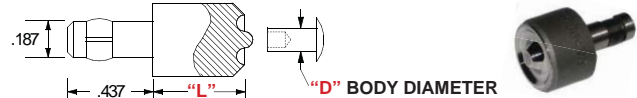

## CA2005 TUBULAR ROLL

RIVET BODY DIAMETER															
"D" 1/16 DIA.		"D" 3/32 DIA.		"D" 1/8 DIA.		"D" 9/64 & 5/32 DIA.		"D" 3/16 DIA.		"D" 1/4 DIA.		"D" 5/16 DIA.		"D" 3/8 DIA.	
"L"	PART No.	"L"	PART No.	"L"	PART No.	"L"	PART No.	"L"	PART No.	"L"	PART No.	"L"	PART No.	"L"	PART No.
1/8	CA2005-01x	1/8	CA2005-1x	1/8	CA2005-8x	1/8	CA2005-15x	1/8	CA2005-22x	1/8	CA2005-29x	1/8	CA2005-36x	1/8	CA2005-43x
1/4	CA2005-01	1/4	CA2005-1	1/4	CA2005-8	1/4	CA2005-15	1/4	CA2005-22	1/4	CA2005-29	1/4	CA2005-36	1/4	CA2005-43
3/8	CA2005-02	3/8	CA2005-2	3/8	CA2005-9	3/8	CA2005-16	3/8	CA2005-23	3/8	CA2005-30	3/8	CA2005-37	3/8	CA2005-44
1/2	CA2005-03	1/2	CA2005-3	1/2	CA2005-10	1/2	CA2005-17	1/2	CA2005-24	1/2	CA2005-31	1/2	CA2005-38	1/2	CA2005-45
5/8	CA2005-04	5/8	CA2005-4	5/8	CA2005-11	5/8	CA2005-18	5/8	CA2005-25	5/8	CA2005-32	5/8	CA2005-39	5/8	CA2005-46
3/4	CA2005-05	3/4	CA2005-5	3/4	CA2005-12	3/4	CA2005-19	3/4	CA2005-26	3/4	CA2005-33	3/4	CA2005-40	3/4	CA2005-47
7/8	CA2005-06	7/8	CA2005-6	7/8	CA2005-13	7/8	CA2005-20	7/8	CA2005-27	7/8	CA2005-34	7/8	CA2005-41	7/8	CA2005-48
1	CA2005-07	1	CA2005-7	1	CA2005-14	1	CA2005-21	1	CA2005-28	1	CA2005-35	1	CA2005-42	1	CA2005-49

The dies on this page fit our Bench Riveter, Hand Squeezers, Pneumatic Squeezers, HT-100 Tool, HR-250 and HR-375, on pages D74, D78, D79, D80 and D81.