



# HANSON RIVET

& SUPPLY CO.  
13241 Weidner Street  
Pacoima, CA 91331

See pages D74-D88 for  
installation tools and machines  
& D89 for installation guide

Phone: 818-485-0500

FAX: 818-485-0540

Outside CA: 1-800-RRRIVET

www.hansonrivet.com



## AEROSPACE SOLID RIVETS

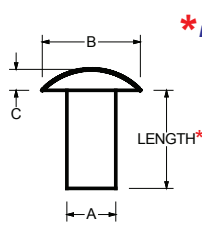
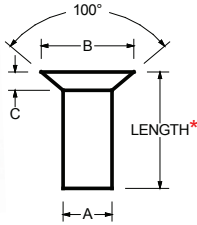

\* LENGTH (in 16ths) = WORK THICKNESS + CLINCH ALLOWANCE "F"

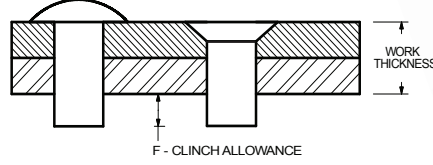

Nominal Body Diameter:

|   |                                 | 1/16        | 3/32        | 1/8         | 5/32        | 3/16        | 1/4         | 5/16        | 3/8         |
|---|---------------------------------|-------------|-------------|-------------|-------------|-------------|-------------|-------------|-------------|
| <b>MS20426</b><br>100° COUNTERSUNK                | "A" BODY DIAMETER               | .061/.065   | .093/.097   | .124/.128   | .155/.159   | .186/.190   | .249/.253   | .311/.315   | .374/.378   |
|   | "B" HEAD DIAMETER               | .110/.118   | .175/.183   | .221/.229   | .282/.290   | .349/.357   | .472/.480   | .560/.568   | .690/.698   |
|   | "C" HEAD HEIGHT                 | .022 REF.   | .036 REF.   | .042 REF.   | .055 REF.   | .070 REF.   | .095 REF.   | .106 REF.   | .134 REF.   |
| <b>MS20427</b><br>100° COUNTERSUNK                | "A" BODY DIAMETER               | .061/.065   | .093/.097   | .124/.128   | .155/.159   | .186/.190   | .249/.253   | .311/.315   | .374/.378   |
|   | "B" HEAD DIAMETER               | .0898/.1346 | .1548/.1900 | .2006/.2360 | .2566/.2976 | .3234/.3654 | .4412/.4890 | .5288/.5772 | .6586/.7074 |
|   | "C" HEAD HEIGHT                 | .0317 MAX.  | .0418 MAX.  | .0483 MAX.  | .0614 MAX.  | .0769 MAX.  | .1034 MAX.  | .1147 MAX.  | .1436 MAX.  |
| <b>AN430</b><br>ROUND HEAD                        | "A" BODY DIAMETER               | .061/.065   | .093/.097   | .124/.1285  | .155/.160   | .186/.191   | .249/.254   | .311/.316   | .374/.379   |
|   | "B" HEAD DIAMETER               | .119/.131   | .178/.196   | .250/.262   | .296/.328   | .356/.394   | .475/.525   | .594/.656   | .713/.787   |
|   | "C" HEAD HEIGHT                 | .042/.052   | .065/.075   | .089/.099   | .112/.122   | .134/.148   | .179/.197   | .222/.246   | .267/.295   |
| <b>MS20435</b><br>ROUND HEAD                      | "A" BODY DIAMETER               | .059/.066   | .090/.097   | .121/.129   | .152/.160   | .183/.192   | .245/.254   | .305/.317   | .365/.380   |
|   | "B" HEAD DIAMETER               | .109        | .166        | .219        | .273        | .327        | .438        | .546        | .656        |
|   | "C" HEAD HEIGHT                 | .047        | .071        | .094        | .117        | .140        | .188        | .234        | .281        |
| <b>AN441</b><br>FLAT HEAD                         | "A" BODY DIAMETER               | .059/.066   | .090/.097   | .121/.129   | .152/.160   | .183/.192   | .245/.254   | .305/.317   | .365/.380   |
|   | "B" HEAD DIAMETER               | .126        | .190        | .250        | .312        | .374        | .500        | .624        | .750        |
|   | "C" HEAD HEIGHT                 | .021        | .032        | .042        | .052        | .062        | .083        | .104        | .125        |
| <b>AN442</b><br>FLAT HEAD                         | "A" BODY DIAMETER               | .061/.065   | .093/.097   | .124/.1285  | .155/.160   | .186/.191   | .249/.254   | .311/.316   | .374/.379   |
|   | "B" HEAD DIAMETER               | .119/.131   | .178/.196   | .238/.262   | .296/.328   | .356/.394   | .475/.525   | .594/.656   | .713/.787   |
|   | "C" HEAD HEIGHT                 | .020/.030   | .033/.043   | .045/.055   | .057/.067   | .070/.080   | .095/.105   | .120/.130   | .143/.157   |
| <b>AN455</b><br>BRAZIER HEAD                      | "A" BODY DIAMETER               | .061/.065   | .093/.097   | .124/.1285  | .155/.160   | .186/.191   | .249/.254   | .311/.316   | .374/.379   |
|   | "B" HEAD DIAMETER               | .148/.164   | .222/.246   | .296/.328   | .371/.411   | .446/.492   | .594/.656   | .742/.820   | .890/.984   |
|   | "C" HEAD HEIGHT                 | .026/.036   | .042/.052   | .057/.067   | .073/.083   | .089/.099   | .119/.131   | .148/.164   | .178/.196   |
| <b>AN456</b><br>MODIFIED BRAZIER HEAD             | "A" BODY DIAMETER               | .061/.065   | .093/.097   | .124/.1285  | .155/.160   | .186/.191   | .249/.254   | .311/.316   | .374/.379   |
|   | "B" HEAD DIAMETER               | .106/.126   | .146/.166   | .225/.245   | .302/.322   | .380/.400   | .458/.478   | .613/.637   | .766/.796   |
|   | "C" HEAD HEIGHT                 | .020/.030   | .026/.036   | .042/.052   | .058/.068   | .073/.083   | .089/.099   | .120/.130   | .151/.161   |
| <b>MS20470</b><br>UNIVERSAL HEAD                  | "A" BODY DIAMETER               | .061/.065   | .093/.097   | .124/.128   | .155/.159   | .186/.190   | .249/.253   | .311/.315   | .374/.378   |
|   | "B" HEAD DIAMETER               | .119/.131   | .178/.196   | .238/.262   | .296/.328   | .356/.394   | .475/.525   | .594/.656   | .713/.787   |
|   | "C" HEAD HEIGHT                 | .027/.037   | .040/.050   | .054/.064   | .067/.077   | .080/.090   | .107/.117   | .133/.143   | .161/.171   |
| <b>MS20613</b><br>UNIVERSAL HEAD                  | "A" BODY DIAMETER               | .061/.065   | .093/.097   | .124/.128   | .155/.160   | .186/.191   | .249/.254   | .311/.316   | .374/.379   |
|   | "B" HEAD DIAMETER               | .119/.131   | .178/.196   | .238/.262   | .296/.328   | .356/.394   | .475/.525   | .594/.656   | .713/.787   |
|   | "C" HEAD HEIGHT                 | .027/.037   | .040/.050   | .054/.064   | .067/.077   | .080/.090   | .107/.117   | .133/.143   | .161/.171   |
| <b>MS20615</b><br>UNIVERSAL HEAD                  | "A" BODY DIAMETER               | .061/.065   | .093/.097   | .124/.128   | .155/.160   | .186/.191   | .249/.254   | .311/.316   | .374/.379   |
|   | "B" HEAD DIAMETER               | .119/.131   | .178/.196   | .238/.262   | .296/.328   | .356/.394   | .475/.525   | .594/.656   | .713/.787   |
|   | "C" HEAD HEIGHT                 | .027/.037   | .040/.050   | .054/.064   | .067/.077   | .080/.090   | .107/.117   | .133/.143   | .161/.171   |
| <b>AN123151 thru AN123450</b><br>UNIVERSAL HEAD   | "A" BODY DIAMETER               | .061/.063   | .093/.095   | .123/.126   | .154/.157   | .186/.189   | .248/.252   | .310/.314   | .373/.377   |
|   | "B" HEAD DIAMETER               | .119/.131   | .179/.197   | .238/.262   | .296/.328   | .356/.394   | .475/.525   | .594/.656   | .713/.787   |
|   | "C" HEAD HEIGHT                 | .027/.037   | .040/.050   | .054/.064   | .067/.077   | .080/.090   | .107/.117   | .133/.143   | .161/.171   |
| <b>AN123451 thru AN135100</b><br>100° COUNTERSUNK | "A" BODY DIAMETER               | .061/.063   | .093/.095   | .123/.126   | .154/.157   | .186/.189   | .248/.252   | .310/.314   | .373/.377   |
|   | "B" HEAD DIAMETER               | .099/.107   | .164/.172   | .210/.218   | .272/.280   | .337/.347   | .460/.470   | .548/.558   | .678/.688   |
|   | "C" HEAD HEIGHT                 | .019/.023   | .033/.037   | .039/.043   | .052/.056   | .067/.071   | .092/.096   | .103/.107   | .131/.135   |
| <b>AN125401 thru AN125700</b><br>UNIVERSAL HEAD   | "A" BODY DIAMETER               | .061/.065   | .093/.097   | .124/.128   | .155/.160   | .186/.191   | .249/.254   | .311/.316   | .374/.379   |
|   | "B" HEAD DIAMETER               | .119/.131   | .178/.196   | .238/.262   | .296/.328   | .356/.394   | .475/.525   | .594/.656   | .713/.787   |
|   | "C" HEAD HEIGHT                 | .027/.037   | .040/.050   | .054/.064   | .067/.077   | .080/.090   | .107/.117   | .133/.143   | .161/.171   |
| <b>NAS508</b><br>UNIVERSAL HEAD                   | "A" BODY DIAMETER               | .061/.065   | .093/.097   | .124/.128   | .155/.160   | .186/.191   | .249/.254   |             |             |
|   | "B" HEAD DIAMETER               | .119/.131   | .178/.196   | .238/.262   | .296/.328   | .356/.394   | .475/.525   |             |             |
|   | "C" HEAD HEIGHT                 | .027/.037   | .040/.050   | .054/.064   | .067/.077   | .080/.090   | .107/.117   |             |             |
| <b>NAS1097</b><br>100° FLUSH SHEAR                | "A" BODY DIAMETER               |             | .093/.097   | .124/.127   | .155/.158   | .186/.189   | .249/.252   |             |             |
|   | "B" HEAD DIAMETER               |             | .1263/.1478 | .1742/.1957 | .2254/.2469 | .2824/.3016 | .3756/.3948 |             |             |
|   | "C" HEAD HEIGHT                 |             | .021 REF.   | .0286 REF.  | .0372 REF.  | .046 REF.   | .060 REF.   |             |             |
| <b>NAS1198</b><br>UNIVERSAL HEAD                  | "A" BODY DIAMETER               | .061/.065   | .093/.097   | .124/.128   | .155/.160   | .186/.191   | .249/.254   |             |             |
|   | "B" HEAD DIAMETER               | .119/.131   | .178/.196   | .238/.262   | .296/.328   | .356/.394   | .475/.525   |             |             |
|   | "C" HEAD HEIGHT                 | .027/.037   | .040/.050   | .054/.064   | .067/.077   | .080/.090   | .107/.117   |             |             |
| <b>NAS1199</b><br>100° COUNTERSUNK                | "A" BODY DIAMETER               | .061/.065   | .093/.097   | .124/.128   | .155/.160   | .186/.190   | .249/.254   |             |             |
|   | "B" HEAD DIAMETER               | .0898/.1346 | .1548/.1900 | .2006/.2360 | .2566/.2976 | .3234/.3654 | .4412/.4890 |             |             |
|   | "C" HEAD HEIGHT                 | .0317 MAX.  | .0418 MAX.  | .0483 MAX.  | .0614 MAX.  | .0769 MAX.  | .1034 MAX.  |             |             |
|   | "F" SUGGESTED CLINCH ALLOWANCE: | .062        | .094        | .125        | .156        | .187        | .250        | .312        | .375        |
|   | SUGGESTED WORK HOLE DIAMETER:   | .067        | .098        | .129        | .161        | .191        | .257        | .323        | .386        |
|   | SUGGESTED DRILL SIZE:           | 51          | 40          | 30          | 20          | 11          | F           | P           | W           |