



STEEL DRIVE RIVETS



BODY DIAMETER "A"	GRIP RANGE "G"	LENGTH "L"	UNIVERSAL HEAD "B" Head Diameter .250 "C" Head Height .054	100° COUNTERSUNK HEAD "B" Head Diameter .219 "C" Head Height .062
.125 1/8	.015-.046	5/32	38-104-01-93	
	.046-.078	5/32	38-104-02-93	
	.078-.109	3/16	38-104-03-93	
	.109-.140	7/32	38-104-04-93	38-604-04-93
	.140-.171	1/4	38-104-05-93	38-604-05-93
	.171-.203	9/32	38-104-06-93	38-604-06-93
	.203-.234	5/16	38-104-07-93	38-604-07-93
	.234-.265	11/32	38-104-08-91	38-604-08-93
	.265-.296	3/8	38-104-09-93	38-604-09-93
	.296-.328	13/32	38-104-10-93	38-604-10-93
	.328-.359	7/16	38-104-11-93	38-604-11-93
	.359-.390	15/32	38-104-12-93	38-604-12-93
	.390-.421	1/2	38-104-13-93	38-604-13-93
	.421-.453	17/32	38-104-14-93	

UNIVERSAL HEAD

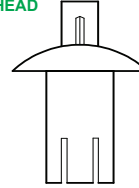

100° COUNTERSUNK

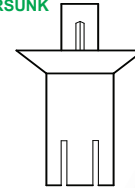

BRAZIER HEAD

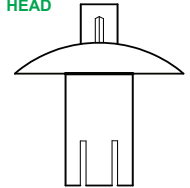

BODY DIAMETER "A"	GRIP RANGE "G"	LENGTH "L"	UNIVERSAL HEAD "B" Head Diameter .375 "C" Head Height .080	100° COUNTERSUNK HEAD "B" Head Diameter .325 "C" Head Height .094	BRAZIER HEAD "B" Head Diameter .469 "C" Head Height .094
.187 3/16	.046-.078	7/32			38-206-02-91
	.078-.109	7/32	38-106-03-91		38-206-03-91
	.109-.140	1/4	38-106-04-91		38-206-04-91
	.140-.171	9/32	38-106-05-91		38-206-05-91
	.171-.203	5/16	38-106-06-91	38-606-06-91	38-206-06-91
	.203-.234	11/32	38-106-07-91	38-606-07-91	38-206-07-91
	.234-.265	3/8	38-106-08-91	38-606-08-91	38-206-08-91
	.265-.296	13/32	38-106-09-91	38-606-09-91	38-206-09-91
	.296-.328	7/16	38-106-10-91	38-606-10-91	38-206-10-91
	.328-.359	15/32	38-106-11-91	38-606-11-91	
	.359-.390	1/2	38-106-12-91	38-606-12-91	
	.390-.421	17/32	38-106-13-91	38-606-13-91	38-206-13-91
	.421-.453	9/16	38-106-14-91	38-606-14-91	38-206-14-91
	.453-.484	19/32	38-106-15-91	38-606-15-91	
	.484-.515	5/8	38-106-16-91	38-606-16-91	38-206-16-91
	.515-.546	21/32	38-106-17-91	38-606-17-91	
	.546-.578	11/16	38-106-18-91	38-606-18-91	
	.578-.609	23/32	38-106-19-91	38-606-19-91	
	.609-.640	3/4	38-106-20-91	38-606-20-91	38-206-20-91

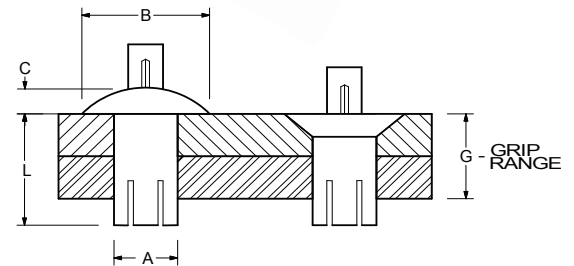

- Blind - install from one side
- Strong shear strength and vibration resistant
- Easy installation with a hammer or power tools
- Simply drive the pin into the head to set the rivet

BODY DIAMETER "A"	GRIP RANGE "G"	LENGTH "L"	UNIVERSAL HEAD "B" Head Diameter .500 "C" Head Height .107	100° COUNTERSUNK HEAD "B" Head Diameter .435 "C" Head Height .125
.250 1/4	.078-.109	7/32	38-108-03-91	
	.109-.140	1/4	38-108-04-91	
	.140-.171	9/32	38-108-05-91	
	.171-.203	5/16	38-108-06-91	38-608-06-91
	.203-.234	11/32	38-108-07-91	38-608-07-91
	.234-.265	3/8	38-108-08-91	38-608-08-91
	.265-.296	13/32	38-108-09-91	38-608-09-91
	.296-.328	7/16	38-108-10-91	38-608-10-91
	.328-.359	15/32	38-108-11-91	38-608-11-91
	.359-.390	1/2	38-108-12-91	38-608-12-91
	.390-.421	17/32	38-108-13-91	38-608-13-91
	.421-.453	9/16	38-108-14-91	38-608-14-91
	.453-.484	19/32	38-108-15-91	38-608-15-91
	.484-.515	5/8	38-108-16-91	38-608-16-91
	.515-.546	21/32	38-108-17-91	38-608-17-91
	.546-.578	11/16	38-108-18-91	38-608-18-91
	.578-.609	23/32	38-108-19-91	38-608-19-91
	.609-.640	3/4	38-108-20-91	38-608-20-91

BODY DIAMETER "A"	GRIP RANGE "G"	LENGTH "L"	UNIVERSAL HEAD "B" Head Diameter .625 "C" Head Height .138
.312 5/16	.094-.156	5/16	38-110-04-91
	.157-.218	3/8	38-110-06-91
	.219-.281	7/16	38-110-08-91
	.282-.343	1/2	38-110-10-91
	.344-.406	9/16	38-110-12-91
	.407-.468	5/8	38-110-14-91
	.469-.531	11/32	38-110-16-91
	.532-.593	3/4	38-110-18-91
	.594-.656	13/32	38-110-20-91
	.657-.718	7/8	38-110-22-91
	.719-.781	15/16	38-110-24-91
	.782-.843	1	38-110-26-91
	.844-.906	1-1/16	38-110-28-91
.907-.968	1-1/8	38-110-30-91	
.969-1.031	1-13/16	38-110-32-91	

BODY DIAMETER "A"	GRIP RANGE "G"	LENGTH "L"	UNIVERSAL HEAD "B" Head Diameter .750 "C" Head Height .166
.375 3/8	.125-.250	1/2	38-112-06-91
	.218-.343	19/32	38-112-09-91
	.312-.437	11/16	38-112-12-91
	.406-.531	25/32	38-112-15-91
	.500-.625	7/8	38-112-18-91
	.593-.718	31/32	38-112-21-91
	.687-.813	1-1/16	38-112-24-91
	.781-.906	1-5/32	38-112-27-91
	.907-.968	1-3/16	38-112-30-91
	.969-1.031	1-1/4	38-112-32-91



AUTHORIZED DISTRIBUTOR