



# HANSON RIVET

& SUPPLY CO.  
13241 Weidner Street  
Pacoima, CA 91331

See pages C43-C46 for  
installation tools

Phone: 818-485-0500

FAX: 818-485-0540

Outside CA: 1-800-RRRIVET

www.hansonrivet.com



## CLOSED-END BLIND RIVETS



Hanson's Closed-End rivets prevent the passage of vapor or liquid through the set rivet. They also provide 100% mandrel retention. This means the head of the mandrel that breaks off stays in the set rivet. This assures that it won't fall into your assembly and rattle around or short out electronics!

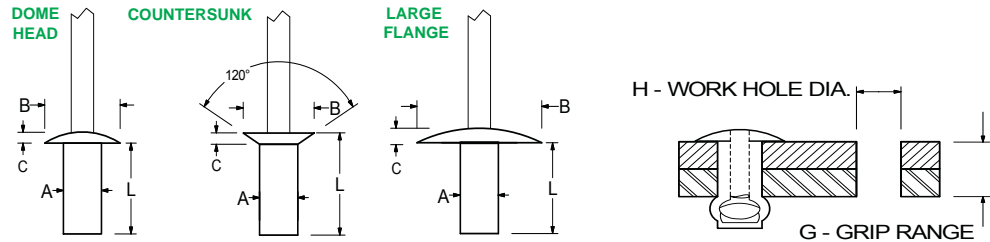

### CLOSED-END SELF SEALING RIVETS

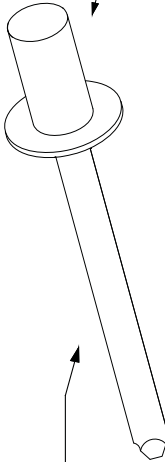
RIVET MATERIAL MANDREL MATERIAL	HEAD STYLE	PART NUMBER	POP®	BODY DIAMETER "A"	WORK HOLE & DRILL SIZE "H"	GRIP RANGE "G"	BODY LENGTH (MAX.) "L"	HEAD DIAMETER (NOM.) "B"	HEAD HEIGHT (MAX.) "C"	TYPICAL ULTIMATE STRENGTHS IN LBS. (SEE NOTE)									
										SHEAR	TENSILE								
<b>ALUMINUM RIVET</b> PLAIN FINISH    <b>STEEL MANDREL</b>  <small>OTHER COLORS AND FINISHES AVAILABLE</small>	DOME HEAD	PASD401H	AD41H	.125 <b>1/8</b>	.129/.133 #30	.032-.062	.252	.236	.051	305	385								
		PASD402H	AD42H																
		PASD403H	AD43H																
		PASD404H	AD44H																
		PASD405H	AD45H																
		PASD406H	AD46H																
		PASD408H	AD48H																
		PASD502H	AD52H									.156 <b>5/32</b>	.160/.164 #20	.063-.125	.330	.312	.066	430	605
		PASD503H	AD53H																
		PASD504H	AD54H																
	PASD505H	AD55H																	
	PASD602H	AD62H	.187 <b>3/16</b>	.192/.196 #11	.063-.125	.345	.375	.081	575	840									
	PASD603H	AD63H																	
	PASD604H	AD64H																	
	PASD605H	AD65H																	
	PASD606H	AD66H																	
	PASD608H	AD68H																	
	PASD610H	AD610H																	
	PASD804H	AD84H	.250 <b>1/4</b>	.257/.261 F	.126-.250	.505	.500	.099	900	1100									
	PASD806H	AD86H																	
	LARGE FLANGE	PASL401H	AD402SBMLF8	.125 <b>1/8</b>	.129/.133 #30	.000-.063	.262	.315	.047	305	385								
		PASL402H	AD404SBMLF8																
		PASL403H	AD406SBMLF8																
		PASL502H	AD504SBMLF10									.156 <b>5/32</b>	.160/.164 #20	.000-.125	.332	.394	.067	430	605
PASL503H		AD506SBMLF10																	
PASL504H		AD508SBMLF10																	
PASL505H		AD510SBMLF10																	
PASL602H		AD604SBMLF11	.187 <b>3/16</b>									.192/.196 #11	.000-.125	.348	.433	.076	575	840	
PASL603H		AD606SBMLF11																	
PASL604H		AD608SBMLF11																	
PASL605H	AD610SBMLF11																		
PASL606H	AD612SBMLF11																		
PASL606H	AD612SBMLF11																		
120° COUNTERSUNK	PASK400H	AK40H	.125 <b>1/8</b>	.129/.133 #30	.040 MAX	.210	.220	.040	305	385									
	PASK401H	AK41H																	
	PASK402H	AK42H																	
	PASK403H	AK43H																	
	PASK404H	AK44H																	
	PASK405H	AK45H																	
	PASK406H	AK46H																	
	PASK501H	AK51H									.156 <b>5/32</b>	.160/.164 #20	.032-.062	.327	.312	.066	430	605	
	PASK502H	AK52H																	
	PASK503H	AK53H																	
	PASK504H	AK54H																	
	PASK505H	AK55H																	
	PASK506H	AK56H																	
	PASK602H	AK62H									.187 <b>3/16</b>	.192/.196 #11	.062-.125	.415	.375	.075	500	690	
PASK604H	AK64H																		
PASK606H	AK66H																		
PASK606H	AK66H																		



**HANSON RIVET**

**& SUPPLY CO.**  
13241 Weidner Street  
Pacoima, CA 91331

See pages C43-C46 for  
installation tools

Phone: 818-485-0500  
FAX: 818-485-0540

Outside CA: 1-800-RRRIVET  
www.hansonrivet.com



# CLOSED-END BLIND RIVETS



Hanson's Closed-End rivets prevent the passage of vapor or liquid through the set rivet. They also provide 100% mandrel retention. This means the head of the mandrel that breaks off stays in the set rivet. This assures that it won't fall into your assembly and rattle around or short out electronics!

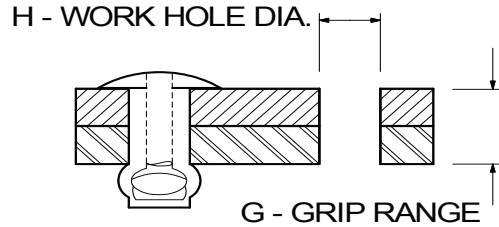
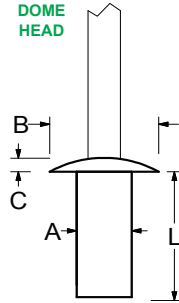

## CLOSED-END SELF SEALING RIVETS

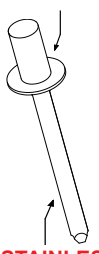
RIVET MATERIAL MANDREL MATERIAL	HEAD STYLE	PART NUMBER	POP®	BODY DIAMETER "A"	WORK HOLE & DRILL SIZE "H"	GRIP RANGE "G"	BODY LENGTH (MAX.) "L"	HEAD DIAMETER (NOM.) "B"	HEAD HEIGHT (MAX.) "C"	TYPICAL ULTIMATE STRENGTHS IN LBS. (SEE NOTE)	
										SHEAR	TENSILE
ALUMINUM RIVET ALUMINUM MANDREL	DOME HEAD	PAAD401AH	AD41AH	.125 1/8	.129/.133 #30	.032-.062 .063-.125 .126-.187 .188-.250	.252 .316 .377 .440	.236	.051	105	150
		PAAD402AH	AD42AH								
		PAAD403AH	AD43AH								
		PAAD404AH	AD44AH	.156 5/32	.160/.164 #20	.063-.250 .251-.312	.455 .517	.150	.240		
		PAAD504AH	AD54AH								
		PAAD505AH	AD55AH								
PAAD602AH	AD62AH	.187 3/16	.192/.196 #11	.063-.125 .126-.250 .251-.375 .376-.500	.345 .470 .595 .720	.220	.310				
PAAD604AH	AD64AH										
PAAD606AH	AD66AH										
PAAD608AH	AD68AH										
ALUMINUM RIVET STAINLESS MANDREL	DOME HEAD	PATD604H	AD64SSH	.187 3/16	.192/.196 #11	.126-.250 .251-.375 .376-.500	.470 .595 .705	.375	.081	575	840
PATD606H	AD66SSH										
PATD608H	AD68SSH										
STAINLESS RIVET  STAINLESS MANDREL	DOME HEAD	PTTD401H	SSD41SSH	.125 1/8	.129/.133 #30	.000-.063 .063-.125 .032-.187 .188-.250 .250-.309	.258 .313 .373 .441 .504	.260	.029	495	495
		PTTD402H	SSD42SSH								
		PTTD403H	SSD43SSH								
		PTTD404H	SSD44SSH	.156 5/32	.160/.164 #20	.125-.187 .188-.250 .250-.309	.392 .461 .523	787	899		
		PTTD405H	SSD45SSH								
		PTTD502H	SSD52SSH								
		PTTD503H	SSD53SSH	.187 3/16	.192/.196 #11	.000-.125 .125-.188 .188-.250 .250-.371 .371-.496	.359 .422 .488 .605 .723	967	989		
		PTTD504H	SSD54SSH								
		PTTD505H	SSD55SSH								
		PTTD602H	SSD62SSH								
		PTTD603H	SSD63SSH	.250 1/4	.257/.261 F	.000-.250 .250-.371 .371-.496	.555 .613 .801	1528	1955		
		PTTD604H	SSD64SSH								
PTTD606H	SSD66SSH										
PTTD608H	SSD68SSH										
STEEL RIVET STEEL MANDREL	DOME HEAD	PSSD403H	SD46SB	.125 1/8	.129/.133 #30	.062-.187	.382	.250	.039	259	270
		PSSD503H	SD56SB								
		PSSD602H	SD64SB	.156 5/32	.160/.164 #20	.062-.187	.401	.312	.047	389	418
		PSSD604H	SD68SB								
COPPER RIVET STEEL MANDREL	DOME HEAD	PCSD403H	CD43H	.125 1/8	.129/.133 #30	.063-.187 .188-.250 .251-.312	.362 .425 .487	.236	.051	270	337
		PCSD404H	CD44H								
		PCSD405H	CD45H								

NOTE: Values for typical ultimate strengths are a guide only and may vary greatly depending upon the application.