



HANSON RIVET

& SUPPLY CO.
13241 Weidner Street
Pacoima, CA 91331

Phone: 818-485-0500

FAX: 818-485-0540

Outside CA: 1-800-RRRIVET

www.hansonrivet.com



CHARTS



SHEET METAL GAUGES

U.S.S. Manufacturers Standard

NO. OF SHEET METAL GAUGE	DECIMAL (APPROX.)	NO. OF SHEET METAL GAUGE	DECIMAL (APPROX.)
3	.2391	17	.0538
4	.2242	18	.0478
5	.2092	19	.0418
6	.1943	20	.0359
7	.1793	21	.0329
8	.1644	22	.0299
9	.1495	23	.0269
10	.1345	24	.0239
11	.1196	25	.0209
12	.1046	26	.0179
13	.0897	27	.0164
14	.0747	28	.0149
15	.0673	29	.0135
16	.0598	30	.0120

CONVERSIONS

FRACTION / DECIMAL / MILLIMETER

FRACTION	DEC MM	FRACTION	DEC MM
1/64	.0156 0.396	33/64	.5156 13.297
1/32	.0312 0.793	17/32	.5312 13.494
3/64	.0468 1.19	35/64	.5468 13.891
1/16	.0625 1.587	9/16	.5625 14.288
5/64	.0781 1.984	37/64	.5781 14.684
3/32	.0937 2.381	19/32	.5937 15.081
7/64	.1093 2.778	39/64	.6093 15.478
1/8	.1250 3.175	5/8	.6250 15.875
9/64	.1406 3.571	41/64	.6406 16.272
5/32	.1562 3.968	21/32	.6562 16.669
11/64	.1718 4.366	43/64	.6718 17.066
3/16	.1875 4.763	11/16	.6875 17.463
13/64	.2031 5.159	45/64	.7031 17.859
7/32	.2187 5.556	23/32	.7187 18.256
15/64	.2343 5.953	47/64	.7343 18.653
1/4	.2500 6.350	3/4	.7500 19.050
17/64	.2656 6.747	49/64	.7656 19.447
9/32	.2812 7.144	25/32	.7812 19.844
19/64	.2968 7.541	51/64	.7968 20.241
5/16	.3125 7.938	13/16	.8125 20.638
21/64	.3281 8.334	53/64	.8281 21.034
11/32	.3437 8.731	27/32	.8437 21.431
23/64	.3593 9.128	55/64	.8593 21.828
3/8	.3750 9.525	7/8	.8750 22.225
25/64	.3906 9.922	57/64	.8906 22.622
13/32	.4062 10.319	29/32	.9062 23.019
27/64	.4218 10.716	59/64	.9218 23.416
7/16	.4375 11.113	15/16	.9375 23.813
29/64	.4531 11.509	61/64	.9531 24.209
15/32	.4687 11.906	31/32	.9687 24.606
31/64	.4843 12.303	63/64	.9843 25.003
1/2	.5000 12.700	1	1.0000 25.400

SOLID RIVET INSTALLATION GUIDE

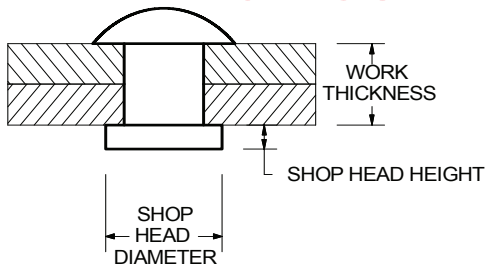

RIVET BODY DIAMETER	SHOP HEAD DIAMETER MIN./MAX.	SHOP HEAD HEIGHT MIN./MAX.
1/16	.080/.110	.020/.040
3/32	.120/.160	.030/.060
1/8	.160/.210	.040/.080
5/32	.200/.270	.050/.100
3/16	.240/.320	.060/.120
1/4	.330/.430	.080/.170
5/16	.410/.530	.110/.210
3/8	.490/.640	.120/.250

This chart is a guide to help determine how much a solid rivet should be squeezed. This is general information and may vary greatly depending upon the application. The "Shop Head" size should generally fall within this table.