



HANSON RIVET

& SUPPLY CO.

13241 Weidner Street
Pacoima, CA 91331

Phone: 818-485-0500

FAX: 818-485-0540

Outside CA: 1-800-RRRIVET

www.hansonrivet.com



HAND RIVET SQUEEZERS



RUGGED
STAINLESS STEEL
CONSTRUCTION!

MODEL	REACH "A"	GAP "B"	"C"	"D"	APPROXIMATE MAXIMUM RIVET LENGTH
HS-15	1.5"	1.25"	.625"	2.75"	1.00"
HS-20	2"	1.25"	.625"	3.25"	1.00"
HS-22	2"	2"	.625"	3.25"	1.75"
HS-30	3"	1.25"	.625"	4.25"	1.00"
HS-40	4"	1.25"	.625"	5.50"	1.00"
HS-50	5"	1.25"	.625"	6.75"	1.00"
HS-60	6"	1.25"	.625"	10.25"	1.00"
HS-100	2"	1"	.625"	2.62"	.750"
HS-101	1"	1"	.625"	2.25"	.750"
HS-102	1.5"	1.25"	.625"	2.50"	1.00"

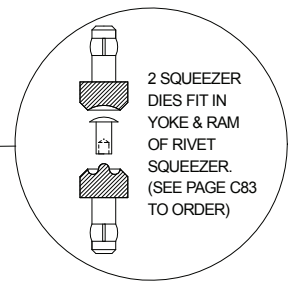
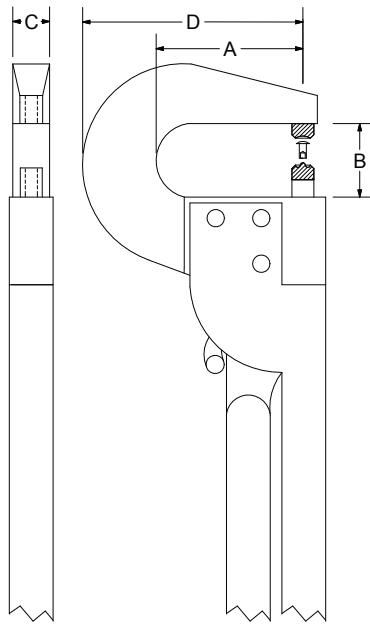

TOOL CAPACITY

Solid aluminum rivets
up to 1/8" diameter

Solid mild steel rivets
up to 3/32" diameter

Tubular mild steel rivets
up to 3/16" diameter

Stroke: .355"